

# ALUMINIUM MINIATUUR FLENSLAGERBLOKKEN

## ALUMINIUM MINIATURE FLANGE UNITS

Aluminium lagerblokken / chromstalen inserts / KFL000 - KFL006 & UFL000 - UFL007

# KFL

Stelbout

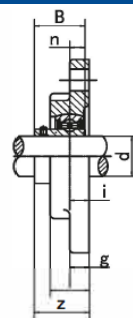
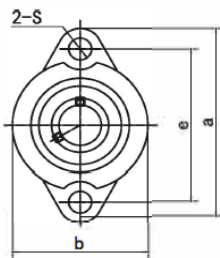

KFL000



Type	Code		Afmetingen ( mm / in. )											Bout	Lagertype	Huis	Gewicht (kg)
	Koyo	Eco	d	a	e	i	g	l	S	b	Z	B	n				
<b>KFL000</b>	250000004	251000004	10	60 2-23/64	45 1-25/35	5,5 7/32	5,5 7/32	11,5 29/64	7,0 9/32	36,0 1-27/64	15,5	14,0 0.551	4,0 0,157	M6	K000	FL000	0,06
<b>KFL001</b>	250001004	251001004	12	63 2-31/64	48 1-57/64	5,5 7/32	5,5 7/32	11,5 29/64	7,0 9/32	38,0 1-1/2	16,0 5/8	14,5 0.571	4,0 0,157	M6	K001	FL001	0,07
<b>KFL002</b>	250002004	251002004	15	67 2-41/64	53 2-3/32	6,5 1/4	6,5 1/4	13,0 33/64	7,0 9/32	42,0 1-21/32	18,6	16,5 0.650	4,5 0,177	M6	K002	FL002	0,10
<b>KFL003</b>	250003004	251003004	17	71 2-51/64	56 2-13/64	7,0 9/32	7,0 9/32	14,0 35/64	7,0 9/32	46,0 1-13/16	19,5 49/64	17,5 0.689	5,0 0,197	M6	K003	FL003	0,13
<b>KFL004</b>	250004004	251004004	20	90 3-35/64	71 2-51/64	8,0 5/16	8,0 5/16	16,0 5/8	10,0 25/64	55,0 2-11/64	23,0	21,0 0.827	6,0 0,236	M8	K004	FL004	0,20
<b>KFL005</b>	250005004	251005004	25	95 3-47/64	75 2-61/64	8,0 5/16	8,0 5/16	16,0 5/8	10,0 25/64	60,0 2-3/8	24,5 31/32	22,5 0.886	6,5 0,256	M8	K005	FL005	0,25
<b>KFL006</b>	250006004	251006004	30	112 4-13/32	85 3-11/32	9,0 23/64	9,0 23/64	18,0 23/32	13,0 33/64	70,0 2-3/4	27,0	24,5 0.965	6,5 0,256	M10	K006	FL006	0,35

# UFL

Excentrische klemring

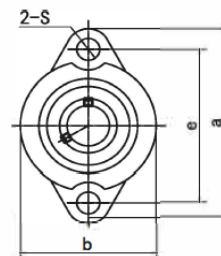
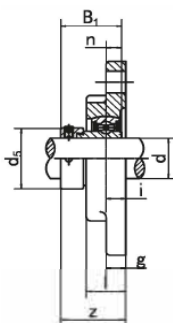

UFL000



Type	Code		Afmetingen ( mm / in. )											Bout	Lager	Huis	Gewicht (kg)	
	Eco		d	a	e	i	g	l	S	b	Z	B1	n					d5
<b>UFL000</b>	253000004		10	60 2-23/64	45 1-25/35	5,5 7/32	5,5 7/32	11,5 29/64	7,0 9/32	36,0 1-27/64	15,5	17,5 0.689	4,0 0,157	17 43/64	M6	U000	FL000	0,06
<b>UFL001</b>	253001004		12	63 2-31/64	48 1-57/64	5,5 7/32	5,5 7/32	11,5 29/64	7,0 9/32	38,0 1-1/2	16,0 5/8	17,5 0.689	4,0 0,157	19 3/4	M6	U001	FL001	0,07
<b>UFL002</b>	253002004		15	67 2-41/64	53 2-3/32	6,5 1/4	6,5 1/4	13,0 33/64	7,0 9/32	42,0 1-21/32	18,6	18,5 0.728	4,5 0,177	22 55/64	M6	U002	FL002	0,10
<b>UFL003</b>	253003004		17	71 2-51/64	56 2-13/64	7,0 9/32	7,0 9/32	14,0 35/64	7,0 9/32	46,0 1-13/16	19,5 49/64	20,5 0.807	5,0 0,197	25 31/32	M6	U003	FL003	0,13
<b>UFL004</b>	253004004		20	90 3-35/64	71 2-51/64	8,0 5/16	8,0 5/16	16,0 5/8	10,0 25/64	55,0 2-11/64	23,0	24,5 0.965	6,0 0,236	30 1-3/16	M8	U004	FL004	0,20
<b>UFL005</b>	253005004		25	95 3-47/64	75 2-61/64	8,0 5/16	8,0 5/16	16,0 5/8	10,0 25/64	60,0 2-3/8	24,5 31/32	25,5 1	6,5 0,256	36 1-27/64	M8	U005	FL005	0,25
<b>UFL006</b>	253006004		30	112 4-13/32	85 3-11/32	9,0 23/64	9,0 23/64	18,0 23/32	13,0 33/64	70,0 2-3/4	27,0	26,5 1,04	6,5 0,256	42 1-21/32	M10	U006	FL006	0,35
<b>UFL007</b>	253007004		35	122 4-51/64	95 3-3/4	10,0 0,3906	10,0 0,3906	20,0 25/32	13,0 33/64	80,0 3-5/32	32,5 1-9/32	29,5 1,161	7,0 0,276	48 1-57/64	M10	U007	FL007	0,50