

KETTINGWIELEN VOOR TRANSPORTKETTING SPROCKETS FOR CONVEYOR CHAINS

P.50 R.25 & P.50 R.31

Steek 50
Rol dia. 25

B1	C	r3
10,5	3	50

Materiaal: Fe

Z	de	dp	Code	dm	D1	A	kg.	Z	de	dp	Code	dm	D1	A	kg.
6	121,0	100,00	B332555006	58	20	40,5	1,11	21	356,5	335,45	B332555021	118	30	60,5	11,71
7	136,0	115,24	B332555007	58	20	40,5	1,37	22	372,5	351,35	B332555022	118	30	60,5	12,20
8	151,5	130,65	B332555008	58	20	40,5	1,55	23	388,0	367,20	B332555023	118	30	60,5	12,47
9	167,0	146,20	B332555009	58	20	40,5	1,89	24	404,0	383,05	B332555024	118	30	60,5	13,00
10	183,0	161,80	B332555010	88	25	45,5	3,10	25	420,0	398,95	B332555025	118	30	60,5	13,98
11	198,5	177,50	B332555011	88	25	45,5	3,44	28	467,5	446,55	B332555028	133	30	62,0	18,62
12	214,0	193,20	B332555012	88	25	45,5	3,79	30	499,5	478,35	B332555030	133	30	62,0	20,29
13	230,0	208,95	B332555013	88	25	45,5	4,17	35	579,0	557,80	B332555035	133	30	62,0	24,57
14	245,5	224,70	B332555014	88	25	45,5	4,63	38	626,5	605,45	B332555038	133	30	62,0	26,97
15	261,5	240,45	B332555015	88	25	45,5	5,09								
16	277,5	256,30	B332555016	118	30	60,5	8,26								
17	293,0	272,11	B332555017	118	30	60,5	9,10								
18	309,0	287,95	B332555018	118	30	60,5	9,26								
19	325,0	303,80	B332555019	118	30	60,5	10,32								
20	340,5	319,60	B332555020	118	30	60,5	10,42								

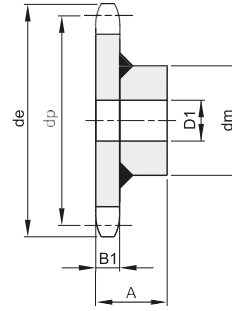
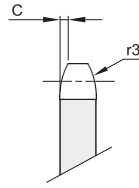

Steek 50
Rol dia. 31

B1	C	r3
13,5	3	50

Materiaal: Fe

Z	de	dp	Code	dm	D1	A	kg.	Z	de	dp	Code	dm	D1	A	kg.
6	120,0	100,00	B332565006	58	20	43,5	1,18	21	355,5	335,45	B332565021	118	30	63,5	12,75
7	135,0	115,24	B332565007	58	20	43,5	1,44	22	371,5	351,35	B332565022	118	30	63,5	13,54
8	150,5	130,65	B332565008	58	20	43,5	1,72	23	387,0	367,20	B332565023	118	30	63,5	14,38
9	166,0	146,20	B332565009	58	20	43,5	2,05	24	403,0	383,05	B332565024	118	30	63,5	15,35
10	182,0	161,80	B332565010	88	25	48,5	3,40	25	419,0	398,95	B332565025	118	30	63,5	16,40
11	197,5	177,50	B332565011	88	25	48,5	3,80	26	435,0	414,80	B332565026	133	30	65,0	18,81
12	213,0	193,20	B332565012	88	25	48,5	4,30	28	466,5	446,55	B332565038	133	30	65,0	21,00
13	229,0	208,95	B332565013	88	25	48,5	4,78	30	498,5	478,35	B332565030	133	30	65,0	23,42
14	244,5	224,70	B332565014	88	25	48,5	5,37	32	530,0	510,10	B332565032	133	30	65,0	25,93
15	260,5	240,45	B332565015	88	25	48,5	5,98	38	625,5	605,45	B332565038	133	30	65,0	32,10
16	276,5	256,30	B332565016	118	30	63,5	9,05								
17	292,0	272,11	B332565017	118	30	63,5	9,60								
18	308,0	287,95	B332565018	118	30	63,5	10,30								
19	324,0	303,80	B332565019	118	30	63,5	11,10								
20	339,5	319,60	B332565020	118	30	63,5	11,90								

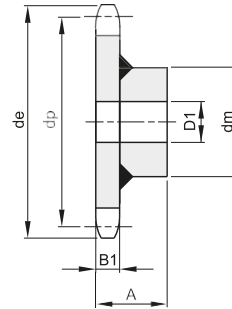
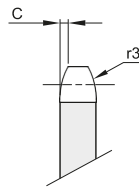

KETTINGWIELEN VOOR TRANSPORTKETTING SPROCKETS FOR CONVEYOR CHAINS

P.50,8 R.30 & P.75 R.25 & P.75 R.31

Steek **50,8**
Rol dia. **30**

B1	C	r3
8,8	3	50

Materiaal: Fe

Z	de	dp	Code	dm	D1	A	kg.	Z	de	dp	Code	dm	D1	A	kg.
8	149,0	132,74	B332570008	58	20	39	1,35								
10	182,0	164,39	B3325700010	88	20	44	2,85								
12	214,0	196,27	B3325700012	88	25	44	3,37								
14	247,0	228,29	B3325700014	88	25	44	4,08								
16	279,0	260,39	B3325700016	118	30	59	7,34								

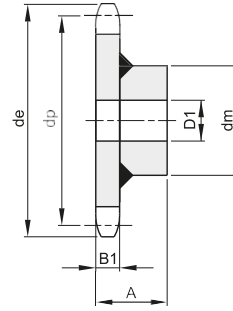
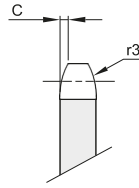

Steek **75**
Rol dia. **25**

B1	C	r3
10,5	3	50

Materiaal: Fe

Z	de	dp	codice	dm	D1	A	kg.	Z	de	dp	codice	dm	D1	A	kg.
8	211,0	195,98	B332600008	88	25	45,5	4,07								
10	258,0	242,70	B3326000010	118	25	60,5	7,87								

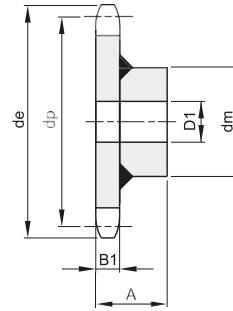
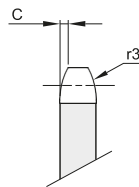

Steek **75**
Rol dia. **31**

B1	C	r3
13,5	3	50

Materiaal: Fe

Z	de	dp	codice	dm	D1	A	kg.	Z	de	dp	codice	dm	D1	A	kg.
6	168,0	150,00	B332610006	88	25	48,5	3,26	13	333,0	313,42	B332610013	118	30	63,5	11,83
8	215,0	195,98	B332610008	88	25	48,5	4,52	14	357,0	337,05	B332610014	118	30	63,5	13,15
9	238,0	219,30	B332610009	88	25	48,5	5,36	15	380,0	360,73	B332610015	118	30	63,5	14,45
10	261,0	242,70	B332610010	118	30	63,5	8,70	16	404,0	384,45	B332610016	133	30	65,0	17,43
11	286,0	266,25	B332610011	118	30	63,5	9,60	20	499,0	479,40	B332610020	133	30	65,0	23,80
12	309,0	289,80	B332610012	118	30	63,5	10,73	21	523,0	503,17	B332610021	133	30	65,0	26,07

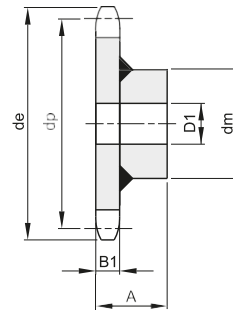
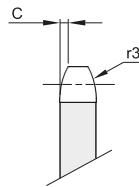

KETTINGWIELEN VOOR TRANSPORTKETTING SPROCKETS FOR CONVEYOR CHAINS

P.100 R.31 & P.100 R.40

Steek 100
Rol dia. 31

B1	C	r3
13,5	3	50

Materiaal: Fe

Z	de	dp	Code	dm	D1	A	kg.
6	218,0	200,00	B332655006	88	25	48,5	4,80
7	249,0	230,48	B332655007	88	25	48,5	5,80
8	280,0	261,31	B332655008	118	30	63,5	9,67
9	311,0	292,40	B332655009	118	30	63,5	10,95
10	342,0	323,61	B332655010	118	30	63,5	12,63
11	375,0	354,95	B332655011	118	30	63,5	14,34
12	406,0	386,40	B332655012	118	30	63,5	16,51
13	437,0	417,90	B332655013	118	30	63,5	18,51
14	469,0	449,40	B332655014	118	30	63,5	20,93
15	500,0	480,97	B332655015	118	30	63,5	23,42
16	532,0	512,60	B332655016	133	30	65,0	27,16

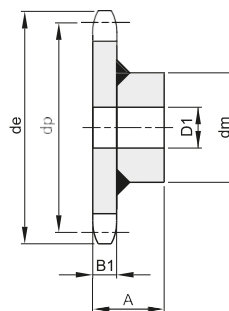

Steek 100
Rol dia. 40

B1	C	r3
20	3	50

Materiaal: Fe

Z	de	dp	Code	dm	D1	A	kg.
6	220,0	200,00	B332660006	118	25	70,0	8,64
7	251,0	230,48	B332660007	118	25	70,0	10,20
8	283,0	261,31	B332660008	118	30	70,0	11,97
9	314,0	292,40	B332660009	118	30	70,0	14,04
10	345,0	323,61	B332660010	118	30	70,0	16,35
11	378,0	354,95	B332660011	118	30	70,0	18,82
12	409,0	386,40	B332660012	118	30	70,0	21,58
13	441,0	417,90	B332660013	118	30	70,0	25,00

