

METEOR ROLLENKetting MET Gummiprofiel

METEOR ROLLER CHAINS WITH MOLDED RUBBER STRIP

UG1 t/m UG15 - simplex & duplex

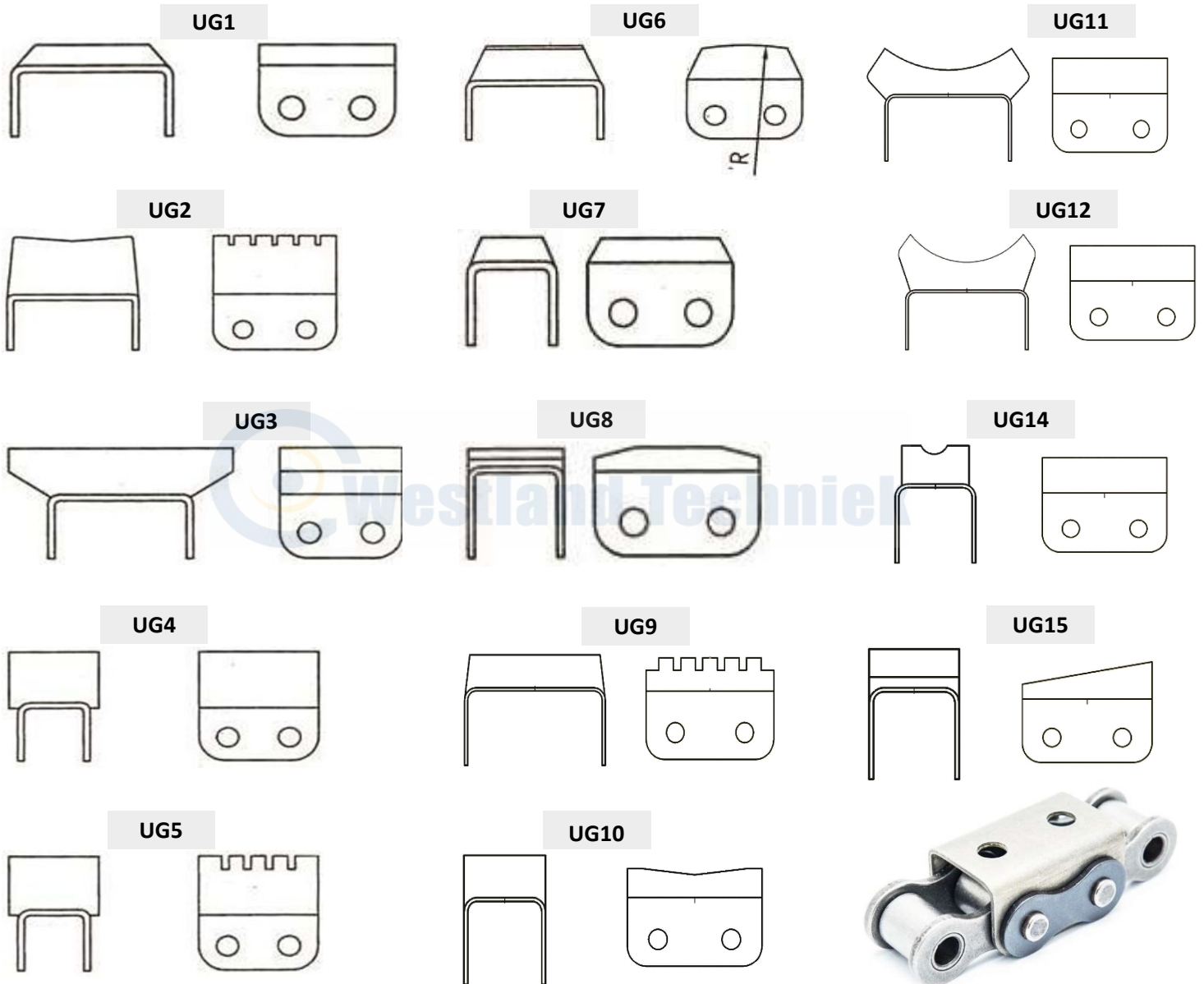
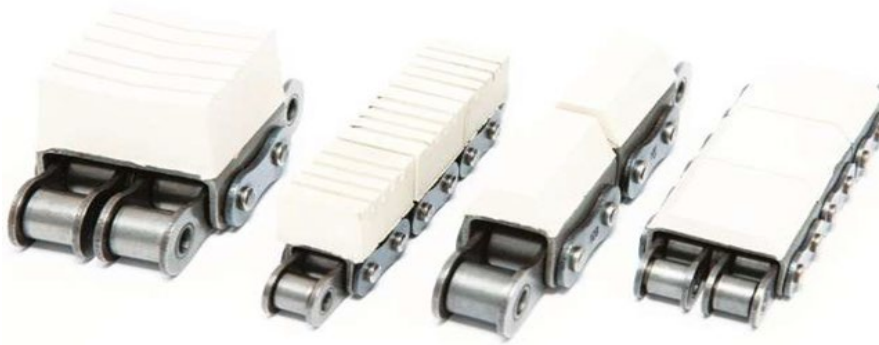

Eigenschappen gummiprofiel

Materiaal		Durometer	Temperatuur		Bestendigheid					
Styreen butadieen rubber		70 +/-	-50° / 90°		Slijtage	Krassen	Ouderdom	Benzine	Olie / vet	Heet water / stoom
++++	+++	++	+	0	+++	++	++	++	++++	++
Uitstekend	Zeer goed	Goed	Matig	Niet geschikt						

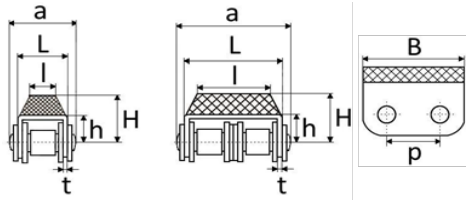

Type	Code	Afmetingen [mm]								Breukbelasting N min
		Steek / p	t	l	L	h	H	a	B	
08B-1 UG1	43508101	12,70	1,3	11,5	14,5	8,3	12,3	19,5	24,32	18200
08B-2 UG1	43508201	12,70	1,3	20,0	28,4	8,3	12,3	33,5	24,32	32000
10B-1 UG1	43510101	15,875	1,3	11,0	16,4	10,5	13,0	21,9	30,0	23000
10B-2 UG1	43510201	15,875	1,3	29,0	33,0	10,5	13,0	38,9	30,0	45400
12B-1 UG1	43512101	19,05	1,8	10,0	19,0	13,0	21,0	25,9	35,6	28900
12B-2 UG1	43512201	19,05	1,8	31,0	39,0	12,0	19,5	45,4	37,0	57800
12A-1 UG1	43512301	19,05	1,8	19,0	21,5	13,9	17,9	29,1	35,0	31800
16B-1 UG1	43516101	25,40	1,8	24,8	30,0	15,4	21,4	39,3	48,0	60000
16B-2 UG1	43516201	25,40	1,8	56,8	62,0	15,4	21,4	70,8	48,0	106000
16A-1 UG1	43516301	25,40	1,8	21,5	26,7	16,4	22,4	36,1	48,0	55600
16A-2 UG1	43516401	25,40	1,8	51,3	56,5	16,4	22,4	65,4	48,0	112000
20B-1 UG1	43520101	31,75	2,4	30,0	34,8	19,0	27,0	46,2	56,15	95000

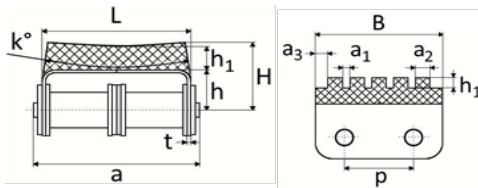

Type	Code	Afm. [mm]		graden °	Afmetingen [mm]						Breukbelasting N min
		Steek / p	t		K	L	h	h1	H	a	
08B-2 UG21	43508102	12,70	1,3	1	28,4	8,3	4,5	16,0	35,1	24,32	32000

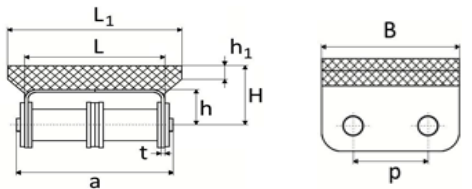

Type	Code	Afmetingen [mm]								Breukbelasting N min	
		Steek / p	t	L1	L	h	h1	H	a		B
08B-2 UG3	43508103	12,70	1,3	44	28,4	8,3	5,0	18,3	33,5	24,32	32000
10B-2 UG3	43510103	15,875	1,3	44	33,0	10,5	2,5	18,3	38,9	30,0	45400

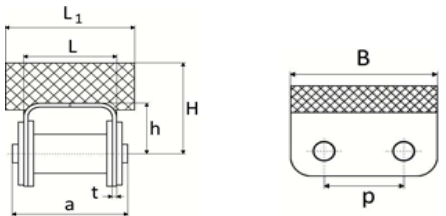

Type	Code	Afmetingen [mm]								Breukbelasting N min
		Steek / p	t	L1	L	h	H	a	B	
08B-1 UG4	43508104	12,70	1,3	18,0	14,5	8,3	20,3	19,5	24,32	18200
08B-1 UG42	43508204	12,70	1,3	18,0	14,5	8,30	13,3	19,5	24,32	18200

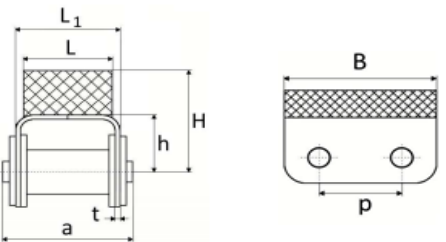

Type	Code	Afmetingen [mm]								Breukbelasting N min
		Steek / p	t	L1	L	h	H	a	B	
12B-1 UG4	43512104	19,05	1,8	18	19,4	13	21	25,9	35,6	28900
12B-1 UG41	43512204	19,05	1,8	18	19,4	13	25	25,9	35,6	28900

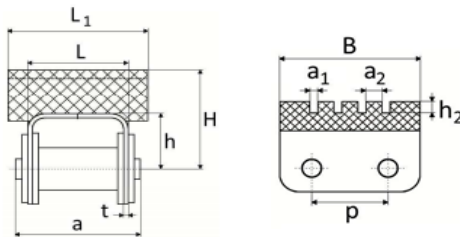

Type	Code	Afmetingen [mm]											Bb.
		Steek / p	t	L1	L	h	H	h2	a1	a2	a	B	
08B-1 UG5	43508105	12,70	1,3	18	14,5	8,3	20,3	3	1,5	3	19,5	24,3	18200
08B-1 UG53	43508205	12,70	1,3	18	14,5	8,3	14,3	3	1,5	3	19,5	24,3	18200

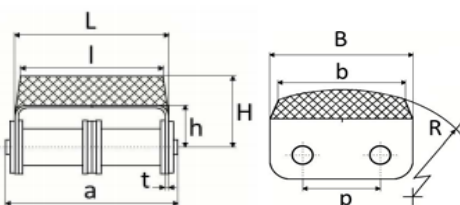

Type	Code	Afmetingen [mm]										Breukbelasting N min
		Steek / p	t	l	L	h	H	a	B	b	R	
08B-2 UG6	43508106	12,70	1,3	20	28,4	8,3	16,3	33,5	24,3	18	55	32000

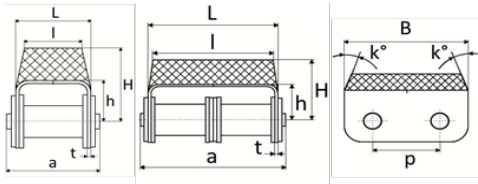

Type	Code	Afm. [mm]		graden °		Afmetingen [mm]					Breukbelasting	
		Steek / p	t	K	l	L	h	H	a	B	N min	
08B-1 UG7	43508107	12,70	1,3	30	9,9	14,5	8,3	12,3	19,5	24,32	18200	
08B-2 UG7	43508207	12,70	1,3	45	20	28,4	8,3	12,3	33,5	24,32	32000	
08B-2 UG71	43508307	12,70	1,3	30	13	28,4	8,3	23,3	33,5	24,32	32000	
12B-1 UG7	43512107	19,05	1,8	25	14	19,6	13	18	25,9	35,6	28900	
16B-1 UG7	43516107	25,40	1,8	30	25	30	21,4	21,4	38,7	48	60000	

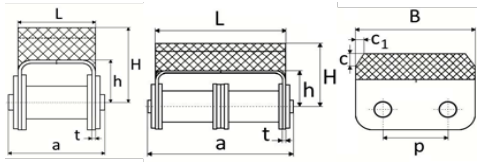

Type	Code	Afm. [mm]		Afmetingen [mm]							Breukbelasting	
		Steek / p	t	L	h	H	c	c1	a	B	N min	
08B-1 UG8	43508108	12,7	1,3	14,5	8,3	12,3	2	5	19,5	24,32	18200	
16B-1 UG8	43516108	25,4	1,8	30	15	21,4	2,9	11,5	39,3	48	60000	
16B-2 UG8	43516208	25,4	1,8	62	15	21,4	2,9	11,5	71,4	48	106000	

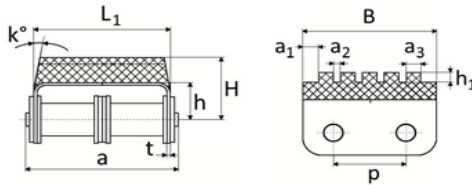

Type	Code	Afm. [mm]		graden °		Afmetingen [mm]								Bb.	
		Steek / p	t	K	L	h	h1	H	a	a1	a2	a3	B	N min	
12B-2 UG9	43512109	19,05	1,8	5	39	12	3	28	45,4	1,5	5	3	37	57800	

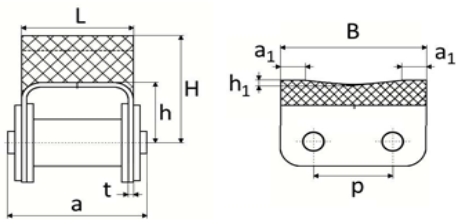

Type	Code	Afm. [mm]		Afmetingen [mm]								Breukbelasting	
		Steek / p	t	L	h	H	h1	a1	a	B	N min		
16B-1 UG10	43516110	25,4	1,8	30	15	25,4	3	4	39,3	48	60000		

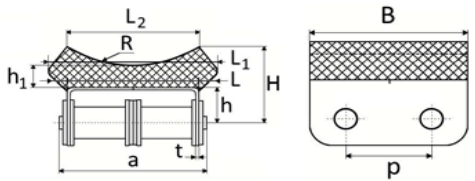

Type	Code	Afm. [mm]		Afmetingen [mm]										Breukbelasting	
		Steek / p	t	L	L1	L2	h	h1	H	R	a	B	N min		
08B-2 UG11	43508111	12,7	1,3	28,4	39	35	8,3	8	20,8	36	33,5	24,32	31800		

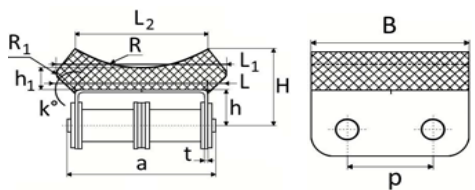

Type	Code	Afm. [mm]		graden °		Afmetingen [mm]								Bb.	
		Steek / p	t	K	L	L1	L2	h	h1	H	R	R1	a	B	N min
08B-2 UG12	43508112	12,7	1,3	60	28	44	42	8,3	8	26,3	27	5	33,5	24,32	31800

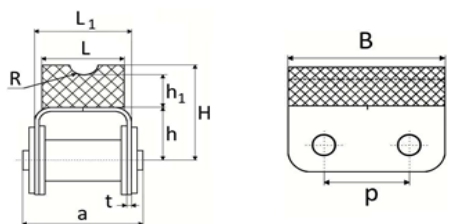

Type	Code	Afm. [mm]		Afmetingen [mm]								Breukbelasting	
		Steek / p	t	R	L1	L	h	h1	H	a	B	N min	
12B-1 UG14	43512114	19,05	1,8	3,6	18	19	13	2,6	23	25,9	35,6	28900	
12B-1 UG141	43512214	19,05	1,8	4,76	18	19	13	3,7	23	25,9	35,6	28900	

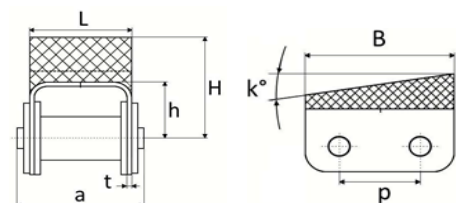

Type	Code	Afm. [mm]		graden °		Afmetingen [mm]					Breukbelasting	
		Steek / p	t	K	L	h	H	a	B	N min		
16B-1 UG15	43516115	25,4	1,8	15	30	15,4	32,9	39,3	48	60000		