

# PLAATWIELEN VOOR TRANSPORTKETTING PLATE WHEELS FOR CONVEYOR CHAINS

P.50 R.25 & P.50 R.31

Steek 50  
Rol dia. 25

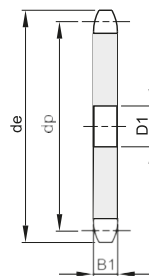
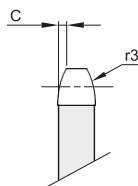

B1	C	r3
10,5	3	50

Materiaal: Fe



Z	de	dp	Code	D1	kg.	Z	de	dp	Code	D1	kg.
6	121,0	100,00	B331555006	20	0,55	21	356,5	335,45	B331555021	30	7,39
7	136,0	115,24	B331555007	20	0,76	22	372,5	351,35	B331555022	30	7,88
8	151,5	130,65	B331555008	20	0,92	23	388,0	367,20	B331555023	30	8,15
9	167,0	146,20	B331555009	20	1,15	24	404,0	383,05	B331555024	30	8,68
10	183,0	161,80	B331555010	25	1,52	25	420,0	398,95	B331555025	30	9,66
11	198,5	177,50	B331555011	25	1,86	28	467,5	446,55	B331555028	30	13,15
12	214,0	193,20	B331555012	25	2,20	30	499,5	478,35	B331555030	30	14,82
13	230,0	208,95	B331555013	25	2,56	35	579,0	557,80	B331555035	30	19,10
14	245,5	224,70	B331555014	25	2,99	38	626,5	605,45	B331555038	30	21,50
15	261,5	240,45	B331555015	25	3,40						
16	277,5	256,30	B331555016	30	3,94						
17	293,0	272,11	B331555017	30	4,73						
18	309,0	287,95	B331555018	30	4,94						
19	325,0	303,80	B331555019	30	6,00						
20	340,5	319,60	B331555020	30	6,10						

Steek 50  
Rol dia. 31

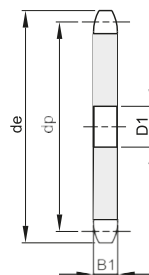
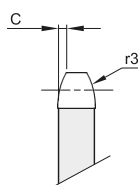

B1	C	r3
13,5	3	50

Materiaal: Fe



Z	de	dp	Code	D1	kg.	Z	de	dp	Code	D1	kg.
6	120,0	100,00	B331565006	20	0,61	21	355,5	335,45	B331565021	30	8,65
7	135,0	115,24	B331565007	20	0,86	22	371,5	351,35	B331565022	30	9,44
8	150,5	130,65	B331565008	20	1,16	23	387,0	367,20	B331565023	30	10,28
9	166,0	146,20	B331565009	20	1,48	24	403,0	383,05	B331565024	30	11,25
10	182,0	161,80	B331565010	25	1,83	25	419,0	398,95	B331565025	30	12,30
11	197,5	177,50	B331565011	25	2,27	26	435,0	414,80	B331565026	30	13,34
12	213,0	193,20	B331565012	25	2,72	28	466,5	446,55	B331565028	30	15,52
13	229,0	208,95	B331565013	25	3,21	30	498,5	478,35	B331565030	30	17,95
14	244,5	224,70	B331565014	25	3,71	32	530,0	510,10	B331565032	30	20,46
15	260,5	240,45	B331565015	25	4,33	38	625,5	605,45	B331565038	30	26,60
16	276,5	256,30	B331565016	30	4,94						
17	292,0	272,11	B331565017	30	5,58						
18	308,0	287,95	B331565018	30	6,30						
19	324,0	303,80	B331565019	30	7,04						
20	339,5	319,60	B331565020	30	7,82						

# PLAATWIELEN VOOR TRANSPORTKETTING PLATE WHEELS FOR CONVEYOR CHAINS

P.50,8 R.30 & P.75 R.25 & P.75 R.31

Steek **50,8**  
Rol dia. **30**

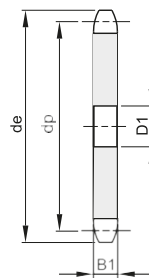
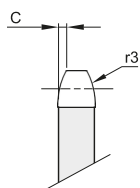

B1	C	r3
8,8	3	50

Materiaal: Fe



Z	de	dp	Code	D1	kg.	Z	de	dp	Code	D1	kg.
8	149,0	132,74	B331570008	20	0,67						
10	182,0	164,39	B331570010	20	1,22						
12	214,0	196,27	B331570012	25	1,81						
14	247,0	228,29	B331570014	25	2,49						
16	279,0	260,39	B331570016	30	3,24						

Steek **75**  
Rol dia. **25**

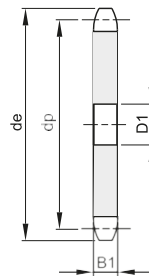
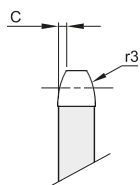

B1	C	r3
10,5	3	50

Materiaal: Fe



Z	de	dp	Code	D1	kg.	Z	de	dp	Code	D1	kg.
8	211,0	195,98	B331600008	25	2,47						
10	258,0	242,70	B331600010	25	3,77						

Steek **75**  
Rol dia. **31**

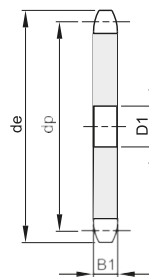
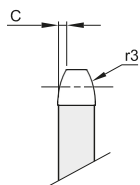

B1	C	r3
13,5	3	50

Materiaal: Fe



Z	de	dp	Code	D1	kg.	Z	de	dp	Code	D1	kg.
6	168,0	150,00	B331610006	25	1,68	13	333,0	313,42	331610013	30	7,80
8	215,0	195,98	B331610008	25	2,94	14	357,0	337,05	331610014	30	9,12
9	238,0	219,30	B331610009	25	3,78	15	380,0	360,73	331610015	30	10,42
10	261,0	242,70	B331610010	30	4,50	16	404,0	384,45	331610016	30	11,98
11	286,0	266,25	B331610011	30	5,57	20	499,0	479,40	331610020	30	18,35
12	309,0	289,80	B331610012	30	6,70	21	523,0	503,17	331610021	30	20,62

# PLAATWIELN VOOR TRANSPORTKETTING PLATE WHEELS FOR CONVEYOR CHAINS

P.100 R.31 & P.100 R.40

Steek 100  
Rol dia. 31

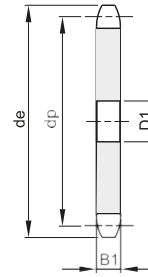
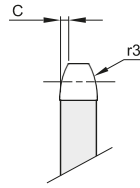

B1	C	r3
13,5	3	50

Materiaal: Fe



Z	de	dp	Code	D1	kg.	Z	de	dp	Code	D1	kg.
6	218,0	200,00	B331655006	25	3,32						
7	249,0	230,48	B331655007	25	4,32						
8	280,0	261,31	B331655008	30	5,50						
9	311,0	292,40	B331655009	30	6,95						
10	342,0	323,61	B331655010	30	8,57						
11	375,0	354,95	B331655011	30	10,29						
12	406,0	386,40	B331655012	30	12,45						
13	437,0	417,90	B331655013	30	14,45						
14	469,0	449,40	B331655014	30	16,84						
15	500,0	480,97	B331655015	30	19,36						
16	532,0	512,60	B331655016	30	21,76						

Steek 100  
Rol dia. 40

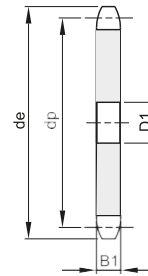
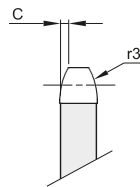

B1	C	r3
20,0	3	50

Materiaal: Fe



Z	de	dp	Code	D1	kg.	Z	de	dp	Code	D1	kg.
6	220,0	200,00	B331660006	25	4,54						
7	251,0	230,48	B331660007	25	6,10						
8	283,0	261,31	B331660008	30	7,87						
9	314,0	292,40	B331660009	30	9,94						
10	345,0	323,61	B331660010	30	12,25						
11	378,0	354,95	B331660011	30	14,72						
12	409,0	386,40	B331660012	30	17,48						
13	441,0	417,90	B331660013	30	20,90						