

KETTING KOPPELING CHAIN COUPLING

DIN 8187

GC

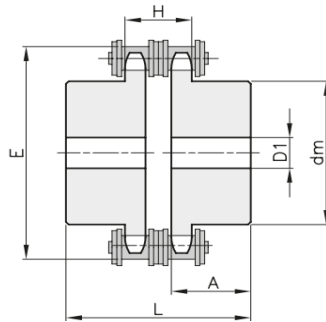

Materiaal: Staal



| Artikel | Code | Ketting (mm) | | | Afmetingen (mm) | | | | | | (Kg) |
|----------|----------|--------------|--------|-------|-----------------|----|----|-------|-------|------|---------|
| | | ISO | Steek | Z | dm | D1 | A | E | L | H | Gewicht |
| GC 06 14 | 58010614 | 06B-2 | 9,525 | 14/14 | 31 | 8 | 25 | 51,0 | 55,0 | 15,6 | 0,42 |
| GC 06 18 | 58010618 | 06B-2 | 9,525 | 18/18 | 43 | 10 | 28 | 63,1 | 61,0 | 15,6 | 0,79 |
| GC 08 14 | 58010814 | 08B-2 | 12,70 | 14/14 | 41 | 10 | 28 | 68,9 | 62,7 | 21,1 | 0,88 |
| GC 08 18 | 58010818 | 08B-2 | 12,70 | 18/18 | 56 | 12 | 28 | 85,0 | 62,7 | 21,1 | 1,49 |
| GC 10 18 | 58011018 | 10B-2 | 15,875 | 18/18 | 70 | 14 | 30 | 106,2 | 67,5 | 25,7 | 2,52 |
| GC 12 18 | 58011218 | 12B-2 | 19,05 | 18/18 | 80 | 16 | 35 | 125,8 | 78,4 | 30,6 | 4,01 |
| GC 12 24 | 58011224 | 12B-2 | 19,05 | 24/24 | 90 | 20 | 40 | 162,1 | 88,4 | 30,6 | 6,39 |
| GC 16 18 | 58011618 | 16B-2 | 25,40 | 18/18 | 100 | 20 | 45 | 167,3 | 105,7 | 48,1 | 9,44 |
| GC 16 24 | 58011624 | 16B-2 | 25,40 | 24/24 | 110 | 20 | 50 | 215,6 | 115,7 | 48,1 | 14,82 |