

PLAATSTALEN FLENSLAGERBLOKKEN ROND

PRESSED HOUSING FLANGE UNITS ROUND

Plaatstalen lagerblokken / SBPF201 - SBPP212 & SAPF201 - SAPP212

SBPF

met stelbout

SAPF

met excentrische klemring



SAPF

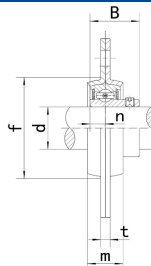
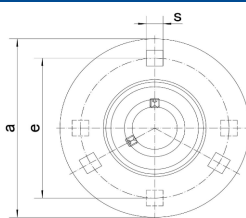
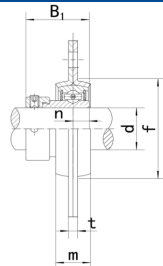

SBPF



Type	Code	Afmetingen (mm / in.)									Bout mm/in.	Lagertype	Huis	Gewicht (kg)
		d	a	e	m	s	t	f	B	n				
SBPF 201	240201001	12	81	63,5	14,0	7,1	4,0	49	22	6	M6	SB201	PF203	0,27
201-8	-	1/2	3-3/16	2-1/2	9/16	9/32	0.157	1-59/64	0.8661	0.2362	1/4	SB201-8	-	-
SBPF 202	240202001	15	81	63,5	14,0	7,1	4,0	49	22	6	M6	SB202	PF203	0,27
202-9	-	9/16	3-3/16	2-1/2	9/16	9/32	0.157	1-59/64	0.8661	0.2362	1/4	SB202-9	-	-
202-10	-	5/8	-	-	-	-	-	-	-	-	-	SB202-10	-	-
SBPF 203	240203001	17	81	63,5	14,0	7,1	4,0	49	22	6	M6	SB203	PF203	0,27
203-11	-	11/16	3-3/16	2-1/2	9/16	9/32	0.157	1-59/64	0.8661	0.2362	1/4	SB203-11	-	-
SBPF 204	240204001	20	90	71,5	16,0	9,0	4,0	56	25	7	M8	SB204	PF204	0,29
204-12	-	3/4	3-35/64	2-13/16	5/8	23/64	0.157	2-13/64	0.9843	0.2756	5/16	SB204-12	-	-
SBPF 205	240205001	25	95	76,0	18,0	9,0	4,0	60	27	7,5	M8	SB205	PF205	0,33
205-13	-	13/16	-	-	-	-	-	-	-	-	-	SB205-13	-	-
205-14	-	7/8	3-3/4	2-63/64	23/32	23/64	0.157	2-23/64	1.0630	0.2953	5/16	SB205-14	-	-
205-15	-	15/16	-	-	-	-	-	-	-	-	-	SB205-15	-	-
205-16	-	1	-	-	-	-	-	-	-	-	-	SB205-16	-	-
SBPF 206	240206001	30	113	90,5	18,0	11,0	5,2	71	30	8	M10	SB206	PF206	0,54
206-17	-	1-1/16	-	-	-	-	-	-	-	-	-	SB206-17	-	-
206-18	-	1-1/8	4-7/16	3-9/16	23/32	7/16	0.205	2-51/64	1.1811	0.3150	3/8	SB206-18	-	-
206-19	-	1-3/16	-	-	-	-	-	-	-	-	-	SB206-19	-	-
206-20	-	1-1/4	-	-	-	-	-	-	-	-	-	SB206-20	-	-
SBPF 207	240207001	35	122	100,0	20,0	11,0	5,2	81	32	8,5	M10	SB207	PF207	0,68
207-20	-	1-1/4	-	-	-	-	-	-	-	-	-	SB207-20	-	-
207-21	-	1-5/16	4-13/16	3-15/16	25/32	7/16	0.205	3-3/16	1.2598	0.3346	3/8	SB207-21	-	-
207-22	-	1-3/8	-	-	-	-	-	-	-	-	-	SB207-22	-	-
207-23	-	1-7/16	-	-	-	-	-	-	-	-	-	SB207-23	-	-
SBPF 208	240208001	40	148	119,0	21,0	13,5	6,8	91	34	9	M12	SB208	PF208	1,14
208-24	-	1-1/2	5-13/16	4-11/16	13/16	17/32	0.268	3-37/64	1.3386	0.3543	1/2	SB208-24	-	-
208-25	-	1-9/16	-	-	-	-	-	-	-	-	-	SB208-25	-	-
SBPF 209	240209001	45	150	120,5	23,0	13,5	6,8	98	41,2	10,2	M12	SB209	PF209	1,21
209-26	-	1-5/8	5-29/32	4-3/4	29/32	17/32	0.268	3-55/64	1.6220	0.402	1/2	SB209-26	-	-
209-27	-	1-11/16	-	-	-	-	-	-	-	-	-	SB209-27	-	-
209-28	-	1-3/4	-	-	-	-	-	-	-	-	-	SB209-28	-	-
SBPF 210	240210001	50	157	127,0	25,0	13,5	8,0	102	43,5	10,9	M12	SB210	PF210	1,49
210-29	-	1-13/16	6-3/16	5	63/64	17/32	0.315	4-1/64	1.7126	0.429	1/2	SB210-29	-	-
210-30	-	1-7/8	-	-	-	-	-	-	-	-	-	SB210-30	-	-
210-31	-	1-15/16	-	-	-	-	-	-	-	-	-	SB210-31	-	-
210-32	-	2	-	-	-	-	-	-	-	-	-	SB210-32	-	-
SBPF 211	240211001	55	168	138,0	26,0	13,5	8,0	113	45,3	11,8	M12	SB211	PF211	1,76
211-32	-	2	6-5/8	5-7/16	1-1/64	17/32	0.315	4-29/64	1.7835	0.465	1/2	SB211-32	-	-
211-33	-	2-1/16	-	-	-	-	-	-	-	-	-	SB211-33	-	-
211-34	-	2-1/8	-	-	-	-	-	-	-	-	-	SB211-34	-	-
211-35	-	2-3/16	-	-	-	-	-	-	-	-	-	SB211-35	-	-
SBPF 212	240212001	60	177	148,0	28,0	13,5	8,0	122	53,7	14,9	M12	SB212	PF212	2,23
212-36	-	2-1/4	6-31/32	5-53/64	1-7/64	17/32	0.315	4-13/16	2.1142	0.587	1/2	SB212-36	-	-
212-37	-	2-5/16	-	-	-	-	-	-	-	-	-	SB212-37	-	-
212-38	-	2-3/8	-	-	-	-	-	-	-	-	-	SB212-38	-	-
212-39	-	2-7/16	-	-	-	-	-	-	-	-	-	SB212-39	-	-

Type	Code	Afmetingen (mm / in.)									Bout mm/in.	Lagertype	Huis	Gewicht (kg)
		d	a	e	m	s	t	f	B1	n				
SAPF 201	-	12	81	63,5	14,0	7,1	4,0	49	22	6	M6	SB201	PF203	0,27
201-8	-	1/2	3-3/16	2-1/2	9/16	9/32	0.157	1-59/64	0.8661	0.2362	1/4	SB201-8	-	-
SAPF 202	-	15	81	63,5	14,0	7,1	4,0	49	22	6	M6	SB202	PF203	0,27
202-9	-	9/16	3-3/16	2-1/2	9/16	9/32	0.157	1-59/64	0.8661	0.2362	1/4	SB202-9	-	-
202-10	-	5/8	-	-	-	-	-	-	-	-	-	SB202-10	-	-
SAPF 203	-	17	81	63,5	14,0	7,1	4,0	49	22	6	M6	SB203	PF203	0,27
203-11	-	11/16	3-3/16	2-1/2	9/16	9/32	0.157	1-59/64	0.8661	0.2362	1/4	SB203-11	-	-
SAPF 204	-	20	90	71,5	16,0	9,0	4,0	56	25	7	M8	SB204	PF204	0,29
204-12	-	3/4	3-35/64	2-13/16	5/8	23/64	0.157	2-13/64	0.9843	0.2756	5/16	SB204-12	-	-
SAPF 205	-	25	95	76,0	18,0	9,0	4,0	60	27	7,5	M8	SB205	PF205	0,33
205-13	-	13/16	-	-	-	-	-	-	-	-	-	SB205-13	-	-
205-14	-	7/8	3-3/4	2-63/64	23/32	23/64	0.157	2-23/64	1.0630	0.2953	5/16	SB205-14	-	-
205-15	-	15/16	-	-	-	-	-	-	-	-	-	SB205-15	-	-
205-16	-	1	-	-	-	-	-	-	-	-	-	SB205-16	-	-
SAPF 206	-	30	113	90,5	18,0	11,0	5,2	71	30	8	M10	SB206	PF206	0,54
206-17	-	1-1/16	-	-	-	-	-	-	-	-	-	SB206-17	-	-
206-18	-	1-1/8	4-7/16	3-9/16	23/32	7/16	0.205	2-51/64	1.1811	0.3150	3/8	SB206-18	-	-
206-19	-	1-3/16	-	-	-	-	-	-	-	-	-	SB206-19	-	-
206-20	-	1-1/4	-	-	-	-	-	-	-	-	-	SB206-20	-	-
SAPF 207	-	35	122	100,0	20,0	11,0	5,2	81	32	8,5	M10	SB207	PF207	0,68
207-20	-	1-1/4	-	-	-	-	-	-	-	-	-	SB207-20	-	-
207-21	-	1-5/16	4-13/16	3-15/16	25/32	7/16	0.205	3-3/16	1.2598	0.3346	3/8	SB207-21	-	-
207-22	-	1-3/8	-	-	-	-	-	-	-	-	-	SB207-22	-	-
207-23	-	1-7/16	-	-	-	-	-	-	-	-	-	SB207-23	-	-
SAPF 208	-	40	148	119,0	21,0	13,5	6,8	91	34	9	M12	SB208	PF208	1,14
208-24	-	1-1/2	5-13/16	4-11/16	13/16	17/32	0.268	3-37/64	1.3386	0.3543	1/2	SB208-24	-	-
208-25	-	1-9/16	-	-	-	-	-	-	-	-	-	SB208-25	-	-
SAPF 209	-	45	150	120,5	23,0	13,5	6,8	98	41,2	10,2	M12	SB209	PF209	1,21
209-26	-	1-5/8	5-29/32	4-3/4	29/32	17/32	0.268	3-55/64	1.6220	0.402	1/2	SB209-26	-	-
209-27	-	1-11/16	-	-	-	-	-	-	-	-	-	SB209-27	-	-
209-28	-	1-3/4	-	-	-	-	-	-	-	-	-	SB209-28	-	-
SAPF 210	-	50	157	127,0	25,0	13,5	8,0	102	43,5	10,9	M12	SB210	PF210	1,49
210-29	-	1-13/16	6-3/16	5	63/64	17/32	0.315	4-1/64	1.7126	0.429	1/2	SB210-29	-	-
210-30	-	1-7/8	-	-	-	-	-	-	-	-	-	SB210-30	-	-
210-31	-	1-15/16	-	-	-	-	-	-	-	-	-	SB210-31	-	-
210-32	-	2	-	-	-	-	-	-	-	-	-	SB210-32	-	-
SAPF 211	-	55	168	138,0	26,0	13,5	8,0	113	45,3	11,8	M12	SB211	PF211	1,76
211-32														