

AXIALE NAALDTAATSLAGER & KOOICONSTRUCTIES AXIAL NEEDLE ROLLER BEARINGS & CAGE ASSEMBLIES

Rollager & kooi - serie AXK, Lagerring - serie AS

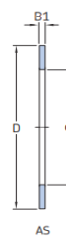
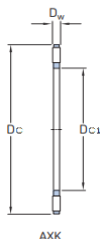

As-dia. (mm)	Code	Type	Gewicht (g)	Code	Lagerring	Gewicht (g)	Afmetingen (mm)				Draaggetallen (N)		Beperkte snelheid Olie (max rpm)
							Dc1/d	Dc/D	Dw	B ₁	Dynamisch C.	Statisch Co.	
4	12200414	AXK 0414 TN	0.7	12300414	AS 0414	1	4	14	2	1	4 380	7 500	20 000
5	12200515	AXK 0515 TN	0.8	12300515	AS 0515	1	5	15	2	1	4 680	9 100	20 000
6	12200619	AXK 0619 TN	1	12300619	AS 0619	2	6	19	2	1	6 740	15 400	18 000
8	12200821	AXK 0821 TN	2	12300821	AS 0821	2	8	21	2	1	7 750	19 000	17 000
10	12201024	AXK 1024	3	12301024	AS 1024	3	10	24	2	1	9 150	24 500	16 000
12	12201226	AXK 1226	3	12301226	AS 1226	3	12	26	2	1	9 860	28 600	14 250
15	12201528	AXK 1528	4	12301528	AS 1528	3	15	28	2	1	11 200	35 500	12 350
17	12201730	AXK 1730	4	12301730	AS 1730	4	17	30	2	1	11 800	38 600	11 400
20	12202035	AXK 2035	5	12302035	AS 2035	5	20	35	2	1	12 900	45 600	9 500
25	12202542	AXK 2542	7	12302542	AS 2542	7	25	42	2	1	13 800	57 800	8 000
30	12203047	AXK 3047	8	12303047	AS 3047	8	30	47	2	1	15 600	69 500	6 500
35	12203552	AXK 3552	10	12303552	AS 3552	9	35	52	2	1	16 900	80 100	6 100
40	12204060	AXK 4060	16	12304060	AS 4060	12	40	60	3	1	27 500	113 500	5 700
45	12204565	AXK 4565	18	12304565	AS 4565	13	45	65	3	1	29 050	127 600	4 750
50	12205070	AXK 5070	20	12305070	AS 5070	14	50	70	3	1	31 500	138 500	4 500
55	12205578	AXK 5578	28	12305578	AS 5578	18	55	78	3	1	37 400	185 000	4 100
60	12206085	AXK 6085	33	12306085	AS 6085	22	60	85	3	1	43 900	232 500	3 800
65	12206590	AXK 6590	35	12306590	AS 6590	24	65	90	3	1	45 800	254 600	3 500
70	12207095	AXK 7095	60	12307095	AS 7095	25	70	95	4	1	53 600	254 600	3 300
75	12215400	AXK 75100	61	12315400	AS 75100	27	75	100	4	1	54 500	264 500	3 100
80	12280105	AXK 80105	63	12380105	AS 80105	28	80	105	4	1	55 600	278 500	2 900
85	12285110	AXK 85110	67	12385110	AS 85110	29	85	110	4	1	57 500	275 000	2 850
90	12290120	AXK 90120	86	12390120	AS 90120	39	90	120	4	1	72 500	401 000	2 500
100	122100135	AXK 100135	104	123100135	AS 100135	50	100	135	4	1	90 500	559 500	2 400
110	122110145	AXK 110145	122	123110145	AS 110145	55	110	145	4	1	96 500	617 500	2 200
120	122120155	AXK 120155	131	123120155	AS 120155	59	120	155	4	1	101 500	679 000	2 000
130	122130170	AXK 130170	205	123130170	AS 130170	65	130	170	5	1	132 400	838 900	1 800
140	122140180	AXK 140180	219	123140180	AS 140180	79	140	180	5	1	137 200	899 000	1 700
150	122150190	AXK 150190	232	123150190	AS 150190	84	150	190	5	1	142 800	959 000	1 600
160	122160200	AXK 160200	246	123160200	AS 160200	89	160	200	5	1	147 600	1 015 000	1 500

TAATS-NAALDLAGER MET CENTREERWAND AXIAL NEEDLE ROLLER BEARINGS WITH CENTRING SPIGOT

Serie AXW

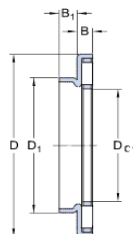

As-dia. (mm)	Code	Type	Gewicht (g)	Afmetingen (mm)					Draaggetallen (N)		Beperkte snelheid Olie (max rpm)
				Dc ₁	D ₁	D	B	B ₁	Dynamisch C.	Statisch Co.	
10	12400010	AXW 10	8.3	10	14	27	3.2	3	9 100	24 000	15 200
12	12400012	AXW 12	9.1	12	16	29	3.2	3	9 400	27 800	13 300
15	12400015	AXW 15	10.1	15	21	31	3.2	3.5	10 500	35 000	12 350
17	12400017	AXW 17	11	17	23	33	3.2	3.5	11 300	38 800	11 400
20	12400020	AXW 20	14	20	26	38	3.2	3.5	12 700	45 600	10 000
25	12400025	AXW 25	19.5	25	32	45	3.2	4	13 900	57 500	7 600
30	12400030	AXW 30	22	30	37	50	3.2	4	15 900	69 500	6 650
35	12400035	AXW 35	26.6	35	42	55	3.2	4	17 000	80 100	6 200
40	12400040	AXW 40	39.2	40	47	63	4.2	4	27 800	109 000	5 200
45	12400045	AXW 45	43.4	45	52	68	4.2	4	29 500	121 600	4 750
50	12400050	AXW 50	49.2	50	58	73	4.2	4.5	31 800	140 900	4 500

COMBI NAALD- & HOEKCONTACTKOGELLAGER NEEDLE ROLLER ANGULAR CONTACT BALL BEARINGS

Serie NKIA 59 (één richting) - Serie NKIB 59 (dubbele richting)

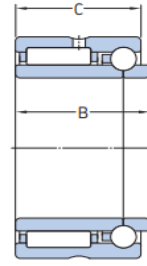
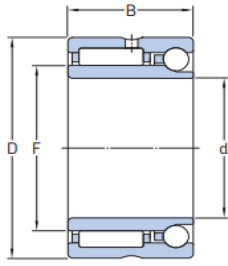

NKIA

NKIB

Materiaal: kunststof kogelkooi - toegestane temperatuur 80° C



NKIA - één richting

As-dia. (mm)	Code	Type	Gewicht (g)	Afmetingen (mm)				Draaggetallen (N)				Beperkte snelheid Olie (max rpm)
				d	F	D	B	Radiaal		Axiaal		
								Dynamisch C.	Statisch Co.	Dynamisch C.	Statisch Co.	
12	12505901	NKIA 5901	40	12	16	24	16	7 200	7 900	2 052	2 138	22 800
15	12505902	NKIA 5902	50	15	20	28	18	10 070	12 900	2 223	2 613	20 900
17	12505903	NKIA 5903	56	17	22	30	18	10 450	13 870	2 375	3 040	19 950
20	12505922	NKIA 5904	103	20	25	37	23	19 950	24 200	3 753	4 608	16 150
22	12505922	NKIA 59/22	118	22	28	39	23	21 660	28 000	4 038	5 320	15 200
25	12505905	NKIA 5905	130	25	30	42	23	22 400	29 900	4 133	5 795	14 250
30	12505906	NKIA 5906	147	30	35	47	23	23 750	33 700	4 513	6 935	12 350
35	12505907	NKIA 5907	243	35	42	55	27	29 900	47 500	5 700	9 310	10 450
40	12505908	NKIA 5908	315	40	48	62	30	40 850	63 650	7 030	12 065	9 000
45	12505909	NKIA 5909	375	45	52	68	30	42 750	69 350	7 315	13 300	8 100
50	12505910	NKIA 5910	380	50	58	72	30	44 650	76 000	7 695	15 105	7 600
55	12505911	NKIA 5911	550	55	63	80	34	55 100	95 000	9 215	18 240	7 100
60	12505912	NKIA 5912	590	60	68	85	34	57 000	102 600	9 500	10 260	6 650
65	12505913	NKIA 5913	635	65	72	90	34	57 950	106 400	9 785	21 185	6 200
70	12505914	NKIA 5914	980	70	80	100	40	79 800	148 200	12 825	27 550	5 700

NKIB - dubbele richting

As-dia. (mm)	Code	Type	Gewicht (g)	Afmetingen (mm)					Draaggetallen (N)				Beperkte snelheid Olie (max rpm)
				d	F	D	B	C	Radiaal		Axiaal		
									Dynamisch C.	Statisch Co.	Dynamisch C.	Statisch Co.	
12	12605901	NKIB 5901	43	12	16	24	17.5	16	7 200	7 900	2 052	2 138	22 800
15	12605902	NKIB 5902	52	15	20	28	20	18	10 070	12 900	2 223	2 613	20 900
17	12605903	NKIB 5903	58	17	22	30	20	18	10 450	13 870	2 375	3 040	19 950
20	12605922	NKIB 5904	107	20	25	37	25	23	19 950	24 200	3 753	4 608	16 150
22	12605922	NKIB 59/22	122	22	28	39	25	23	21 660	28 000	4 038	5 320	15 200
25	12605905	NKIB 5905	134	25	30	42	25	23	22 400	29 900	4 133	5 795	14 250
30	12605906	NKIB 5906	151	30	35	47	25	23	23 750	33 700	4 513	6 935	12 350
35	12605907	NKIB 5907	247	35	42	55	30	27	29 900	47 500	5 700	9 310	10 450
40	12605908	NKIB 5908	320	40	48	62	34	30	40 850	63 650	7 030	12 065	9 000
45	12605909	NKIB 5909	380	45	52	68	34	30	42 750	69 350	7 315	13 300	8 100
50	12605910	NKIB 5910	385	50	58	72	34	30	44 650	76 000	7 695	15 105	7 600
55	12605911	NKIB 5911	555	55	63	80	38	34	55 100	95 000	9 215	18 240	7 100
60	12605912	NKIB 5912	595	60	68	85	38	34	57 000	102 600	9 500	10 260	6 650
65	12605913	NKIB 5913	640	65	72	90	38	34	57 950	106 400	9 785	21 185	6 200
70	12605914	NKIB 5914	985	70	80	100	45	40	79 800	148 200	12 825	27 550	5 700