

## Ball Bearing Units

### Thermoplastic Housed 2-Bolt Flange Units

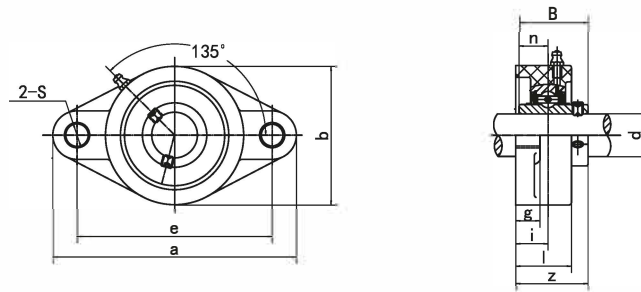

Unit NO.	Dimensions ( mm / in. )											Max.Torque		Bearing NO.	Housing No.	Weight (kg)
	d	a	e	b	g	l	s	z	i	B	n	Bolt D	Nm			
SS-UCFLPL204	20 3/4	130.0 5-1/8	90.0 3-35/64	70.0 2-3/4	11.4 29/64	26.5 1-3/64	11.0 7/16	33.7 1-21/64	15.4 39/64	31.0 1.221	12.7 0.500	M10 3/8	18	SS-UC204	FLPL204	0.24
SS-UCFLPL205	25 13/16 ; 7/8 ; 15/16 ; 1	131.0 5-5/32	99.0 3-57/64	69.5 2-47/64	13.5 17/32	29.1 1-9/64	11.0 7/16	36.7 1-7/16	17.0 43/64	34.1 1.343	14.3 0.563	M10 3/8	25	SS-UC205	FLPL205	0.30
SS-UCFLPL206	30 1-1/16 ; 1-1/8 ; 1-3/16 ; 1-1/4	148.0 5-53/64	117.0 4-39/64	80.0 3-5/32	13.3 17/32	30.5 1-13/64	11.0 7/16	41.2 1-5/8	19.0 3/4	38.1 1.500	15.9 0.626	M10 3/8	30	SS-UC206	FLPL206	0.45
SS-UCFLPL207	35 1-1/4 ; 1-5/16 ; 1-3/8 ; 1-7/16	164.0 6-29/64	130.0 5-1/8	90.0 3-35/64	16.1 41/64	32.8 1-19/64	13.0 33/64	43.4 1-45/64	18.0 45/64	42.9 1.689	17.5 0.689	M12 7/16	35	SS-UC207	FLPL207	0.66
SS-UCFLPL208	40 1-1/2 ; 1-9/16	176.0 6-59/64	144.0 5-43/64	100.0 3-15/16	20.0 25/32	37.5 1-15/32	14.0 35/64	51.7 2-1/32	21.5 27/32	49.2 1.937	19.0 0.748	M12 7/16	40	SS-UC208	FLPL208	0.87
SS-UCFLPL209	45 1-5/8 ; 1-11/16 ; 1-3/4	188.5 7-27/64	148.5 5-27/32	108.0 4-15/64	21.0 53/64	41.0 1-39/64	17.0 43/64	54.2 2-9/64	24.0 15/16	49.2 1.937	19.0 0.748	M16 5/8	45	SS-UC209	FLPL209	1.00
SS-UCFLPL210	50 1-13/16 ; 1-7/8 ; 1-15/16 ; 2	197.0 7-3/4	157.0 6-3/16	115.0 4-17/32	21.0 53/64	43.0 1-11/16	17.0 43/64	57.6 2-17/64	25.0 63/64	51.6 2.032	19.0 0.748	M16 5/8	50	SS-UC210	FLPL210	1.20
SS-UCFLPL211	55 2 ; 2-1/16 ; 2-1/8 ; 2-3/16	224.0 8-13/16	184.0 7-1/4	130.0 5-1/8	18.0 45/64	43.0 1-11/16	19.0 3/4	58.4 2-19/64	25.0 63/64	55.6 2.189	22.2 0.874	M16 5/8	55	SS-UC211	FLPL211	1.42
SS-UCFLPL212	60 2-1/4 ; 2-5/16 ; 2-3/8 ; 2-7/16	250.0 9-27/32	202.0 7-61/64	140.0 5-33/64	18.0 15/64	48.0 1-57/64	23.0 29/32	68.7 2-45/64	29.0 1-9/64	65.1 2.563	25.4 1.000	M16 3/4	60	SS-UC212	FLPL212	1.60